

APS BATTERIES Manual

[Specifications](#)

[Description](#)

[Package Contents](#)

[Precautions](#)

[Recommendations for Battery Use](#)

[Battery Charging](#)

[Installing the Battery Pack into Device](#)

[Legal Compliances and Disclaimers](#)

Specifications

Model	APS 3
SKU	79161
Capacity, mAh	3200
Rated voltage,V	3.7
Full charge time, h	3.5
Cycle life, at least	300
Mains voltage range, V	100-240
Output voltage of mains charger, V	5
Charge/discharge temperature range (RH 60±5%)	0 ... 45 °C / -20 ... +60 °C
Dimensions, mm	74×24×24
Weight, kg	0.06

Description

Rechargeable Li-Ion batteries Battery Pack **APS2 / APS3** are designed to be used with digital and thermal riflescopes Pulsar (Thermion, Digex etc.), monoculars Axion (APS3), binoculars Merger (APS3) and to significantly increase their self-contained operating time.

Package Contents

- Battery Pack APS2 / APS3
 - User manual
 - Warranty card
-

Precautions

- Only use the charger supplied with the Battery Pack (may not be included). The use of any other charger may irreparably damage the Battery Pack or the charger and may cause fire.
 - Do not charge the battery immediately after bringing it from cold to warm. Wait at least 30 minutes for the battery to warm up.
 - It is not recommended to charge the batteries with a charger connected to the USB port of a computer or laptop. It can damage the computer.
 - Do not leave the battery unattended while charging.
 - Do not use the charger if it has been modified or damaged.
 - Do not leave the battery in a charger connected to the mains after charging is complete.
 - Do not expose the battery to high temperatures or naked flames.
 - Do not use the battery as a power source for devices that do not support APS batteries.
 - Do not disassemble or deform the battery or charger.
 - Do not drop or strike the battery or charger.
 - The battery and charger must not be immersed in water.
 - Keep the battery out of the reach of children.
-

Recommendations for Battery Use





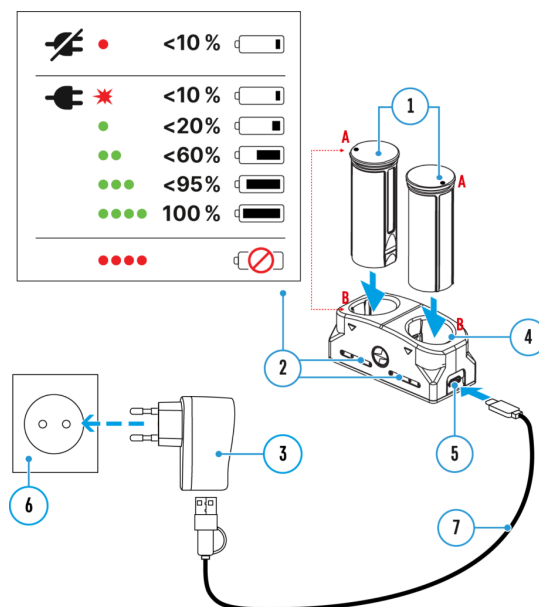



- The batteries should be partially charged (50 to 80 %) for long-term storage.
 - The battery is to be charged at an ambient temperature of 0 °C to +35 °C or the lifespan of the battery will decrease significantly.
 - When using the battery at sub-zero ambient temperatures, the battery capacity decreases. This is normal and not a defect.
 - Do not use the battery at temperatures outside the range of -25 °C to +40 °C or it may reduce battery life.
 - The battery is short circuit protected. However, any situation that may cause short-circuiting should be avoided.
-

Battery Charging



1. Install the rechargeable battery (1) along the guides until stop into the charger's (4) slot. Charger will be supplied with your Pulsar device or bought separately.
2. Spot A on the battery and spot B on the charger should match (see image).

3. You can charge two batteries at the same time – a second slot is designed for this purpose.
4. Connect the plug of the USB cable (not included) **(7)** into the port **(5)** of the charger **(4)**.
5. Connect the other plug of the USB cable **(7)** to the jack of the mains charger **(3)**.
6. Plug the mains charger **(3)** into a socket 100-240V **(6)**.
7. LED indicator **(2)** will show battery charge status (see the table).

(2) LED Indicator*	Battery charge status
	Battery charge from 0 to 10%. Charger connected to the mains power supply
	Battery charge from 0 to 10%. Charger not connected to the mains power supply
	Battery charge from 10 to 20%
	
	Battery charge from 20 to 60%
	
	Battery charge from 60 to 95%
	
	Battery completely charged. Charging will automatically stop. The battery can be disconnected from the charger.



Battery defective. Do not use the battery!

* Indication shows the current battery charge level for 30 seconds if the APS charger is not connected to the mains. Once connected to the mains, indication shows current battery charge level permanently. LED indicators also glow showing charging process.

Installing the Battery Pack into Device

Install the Battery Pack into the designated slot in the housing of your optical device as instructed in the user manual of your thermal or digital device.

Legal Compliances and Disclaimers

Updates of the Product. The manufacturer reserves the right at any time, without mandatory prior notice to the Customer, to make changes to the package contents (subject to the applicable laws, if any), design and characteristics that do not impair the quality of the Product.

Repair. warranty for the Battery Pack is one year.

Limitation of Liability. Subject to mandatory applicable laws and regulations: manufacturer will not be liable for any claims, actions, suits, proceedings, costs, expenses, damages or liabilities (if any), arising out of the use of this product. Operation and use of the product are the sole responsibility of the Customer. Manufacturer's sole undertaking is limited to providing the product(s) and related services in accordance with the terms and conditions of concluded transactions, including provisions established in warranty. The provision of products sold and services performed by Manufacturer to the Customer shall not be interpreted, construed, or regarded, either

expressly or implied, as being for the benefit of or creating any obligation toward any third party (other than Distributor, Dealer, Buyer). Manufacturer's liability hereunder for damages, regardless of the form or action, shall not exceed the fees or other charges paid to Manufacturer for the product(s) and/or service(s).

MANUFACTURER WILL NOT BE LIABLE FOR LOST REVENUES OR INDIRECT, SPECIAL, INCIDENTAL, CONSEQUENTIAL, EXEMPLARY, OR PUNITIVE DAMAGES, EVEN IF THE MANUFACTURER KNEW OR SHOULD HAVE KNOWN THAT SUCH DAMAGES WERE POSSIBLE AND EVEN IF DIRECT DAMAGES DO NOT SATISFY A REMEDY.

For technical support please contact support@pulsar-vision.com.

Answers to frequently asked questions about the devices can also be found in the **FAQ** section.

